



Classic *Square Edge*

The traditional self-edge profile is both clean and crisp. The perfect 90° profile is a timeless original, desirable in both Commercial and Residential settings.

The future is beyond flat. Experience VT Dimensions.

The Classic edge profile adds dimensional beauty and character to VT Dimensions countertops.

More than just a flat surface, VT Dimensions bring everything together into one seamless and contoured offering—with the depth, the style, and seamless edge you want.

Experience a whole new dimension in countertops with VT Dimensions.

Specifications

- Standard substrate is $\frac{3}{4}$ " industrial-grade particleboard, available in 8', 10', and 12' lengths
- Standard postformed-grade laminate with a thickness of 0.042" + 0.002" - 0.008"
- Both standard and special styles and sizes are suitable for all residential, commercial, institutional, or light-industrial applications
- Available surfaced with Capture by VT Dimensions®, Formica®, Nevamar®, Pionite®, and Wilsonart® laminate
- Available as an environmentally friendly EQcountertop

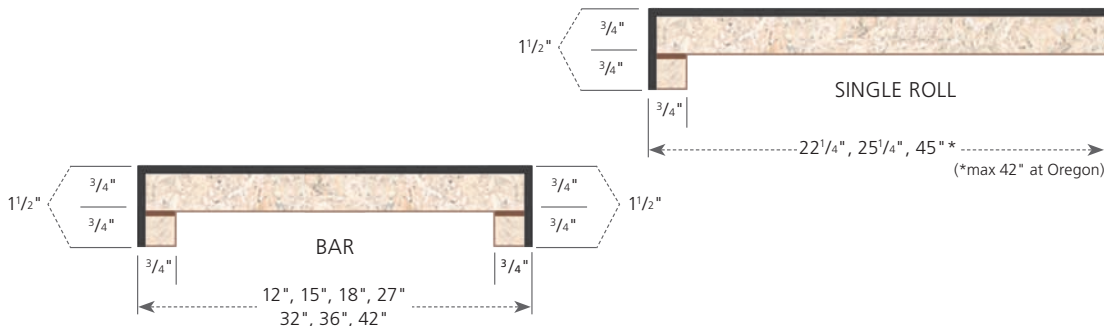
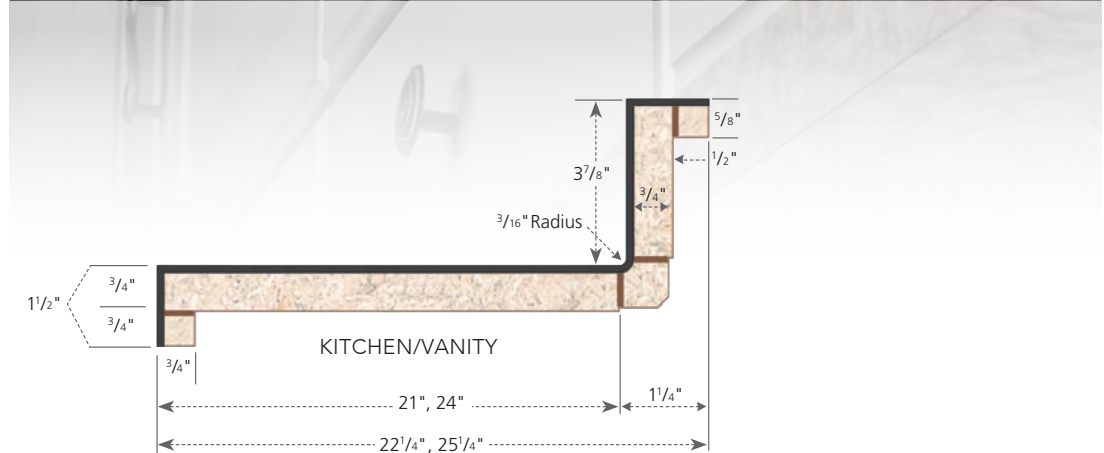

All measurements in inches. Drawings not to scale.



VTDimensions.com | 1-888-287-8356
1000 Industrial Park | P.O. Box 490 | Holstein, IA 51025