

TOP RAIL:

SCL

VERTICAL STILES:

SCL, matching wood edge available

CORE:

SCLC

CROSSBANDS:

HDF; 20% of door construction weight, composed of pre-consumer recycled material

FACES:

Wood veneer "A" grade, unless otherwise specified, Mill Option Paintable Surface

MIRROR:

1/4" with safety film

FINISHED THICKNESS:

1-3/4" or 2-1/4"

BOTTOM RAIL:

SCL

All dimensions shown are nominal before sanding, trimming and prefitting within industry standards. Specifications may be changed at manufacturer's option. Prefit and stock sizes available.

Flush Mirror

Mirror is bonded into a mortise within the face.

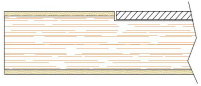

Recessed Mirror

Mirror is installed in a deeper face mortise and secured with mastic and/or glazing bead.

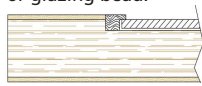

Surface-Applied Mirror

Mirror is bonded to face of door & secured around its perimeter with overlapping applied molding.

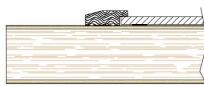

LEED V4 Credit Assistance Available

MR - Building Life Cycle Impact Reduction - Option 4	X
MR - Extraction / Manufacture Valuation Factor	X
MR - BPDO Environmental Product Declarations - Option 1	X
MR - BPDO Sourcing of Raw Materials - Option 2	X
MR - BPDO - Material Ingredients - Option 1	X
EQ - Low-Emitting Materials	X

Consult VT for project specific LEED compliance documentation. FSC available by request.

AWS/WDMA CUSTOM GRADE EXTRA HEAVY DUTY DOOR

DOOR FEATURES:

Standard Finish Type: WDMA TR-8/AWS System 9 (UV Cured Acrylated Polyurethane). Doors must be factory clear, stain or opaque. Unfinished and primer is not available.

Veneer Match: Book match standard. Slip or random available.

Veneer Face Assembly: Running match standard. Center or balanced available.

Pairs and Sets: Pair match standard, set match available.

Doors/Transoms: Continuous match standard. End or no match available.

Vertical Edges: (Visible surface) Matching wood finished to match the face.

Cutouts: 5" minimum distance from door edge and the minimum distance between lite

Standard Bevel: 1/8" in 2" or 3 degrees.

Clearances: 1/8" top, 1/8" lock and hinge stiles. See NFPA-80 6.3.1.7.1, 2013 Edition. Bottom clearance 3/4" max (bottom of the door to top finish floor). See NFPA-80 4.8.4.1, 2013 edition.

Security Rating: Class 40 (highest rating possible)

STC Rating: See STC chart for requirements.

Screw Holding: Refer to Customer Service Update #CS119F (www.vtindustries.com/doors/csupdates)

DOOR STANDARDS:

- WDMA I.S. 1-A-2013 and AWS, Edition 2, Section 9 Quality Standards (Bonded Core).
- Top and bottom rails of door shall be factory sealed.
- Doors shall be clad in AWS/WDMA custom wood veneer "A" grade with minimum thickness 1/42" before sanding, with Type 1 adhesive containing no added urea-formaldehyde. Both domestic and exotic hardwood species available for transparent finish. Premium "AA" grade wood veneer available by request.
- Mill option paintable surface for opaque finish door construction will be 3-ply. HDF faces adhered to core material. No crossbanding.
- Factory finished wood glazing stops or beige powder coated metal lite frames shall be furnished for lite openings. Metal lite frames may be veneer-wrapped at additional cost.
- See STC chart for lite sizes and glass requirements by STC rating.
- Hardware preparation: All cutouts for mortise hardware shall be made at the factory from hardware manufacturer's templates and approved shop drawings.
- Doors shall be individually poly-bagged for protection in transit and storage periods, and shall be marked as per tag openings on shop drawings.
- Door bottoms, sweeps, thresholds, gasketing, lite kits and glass may be supplied by others or VT.