

## INSTALLATION INSTRUCTIONS

Includes:

- NGP 225S Mortise automatic door bottom
- NGP 5075 Triple fin smoke seal
- NGP 5060 Silicone fin smoke seal
- NGP 60FP Acoustical foam pad (x2)

1. Install the NGP 225S door bottom in accordance with the manufacturer's instructions prior to hanging the door. **See drawing #1.**
2. Turn the adjustment screw on the door bottom in so that the seal will not activate when the door is closed.
3. Hang the door and adjust for proper clearances.
4. Prepare the frame by cleaning the jamb, header and stops where the NGP 5075 and NGP 5060 seals will be applied.
5. Measure, cut and apply the NGP 5075 and NGP 5060 seals to the frame jambs and header, locating the NGP 5075 on the frame stop and the NGP 5060 on the frame jamb. **See drawing #2.** The NGP 5075 and NGP 5060 should be full opening width on the top, with the vertical legs extending from the top of the threshold and butted against the top strip. Use full-length pieces to avoid joint gaps.
6. Apply NGP 60FP (x2) to bottom corners of jambs. **See drawing #3.**
7. Turn the adjustment screw on the door bottom out to the point where the seal makes uniform firm contact with the floor when the door is closed.

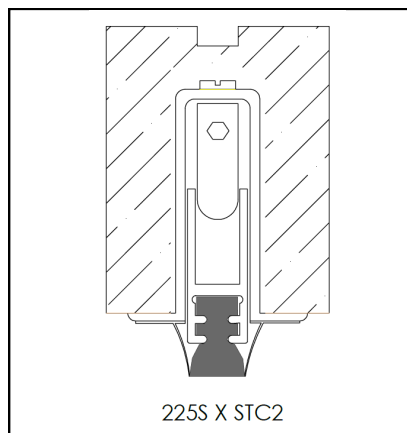

**Drawing #1**

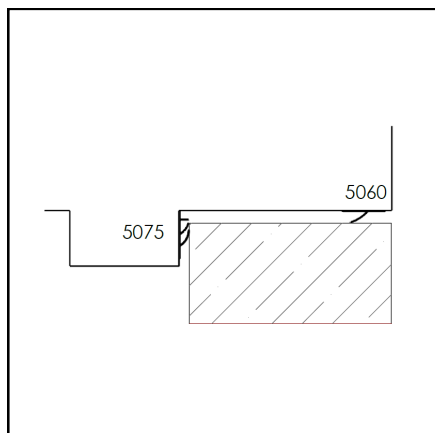

**Drawing #2**

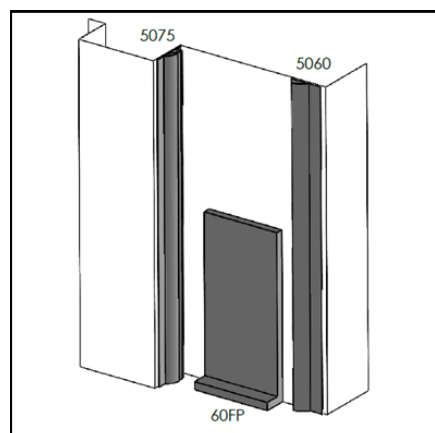

**Drawing #3**