

All dimensions shown are nominal before sanding, trimming and prefitting within industry standards. Specifications may be changed at manufacturer's option. Prefit and stock sizes available.

#Contain no added urea-formaldehyde.  
\*No added urea-formaldehyde or FSC Certified must be specified.

**Blocking Reinforcement Options:** available at additional cost for undercutting and specialized hardware. Blocking recommended for Extra Heavy Duty Doors using surface mounted hardware.

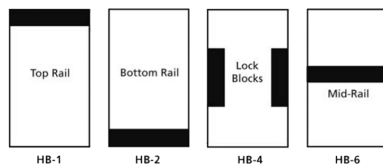

**LEED Version 3 Credit Assistance**

Recycled Material MR 4: 1-2 points	X
Regional Material MR 5: 1-2 points	X
Certified Wood MR 7: SCS-COC-004128	X
Low-Emitting Material EQ 4.4*	X

Credit assistance available for multiple LEED rating systems

**AWS/WDMA PREMIUM GRADE EXTRA HEAVY DUTY DOOR**

**DOOR FEATURES:**

**Finish Type:** Woodgrains, Solid Colors & Patterns.

**Laminate Match:** Horizontal grade - standard (HGS)

**Vertical Edges:**

(visible surface) Same as face material laminated (-3) with edge-before-face construction. Optional edges are: unfinished (-1), finished at factory (-2), and painted at factory (-4) with a mill option hardwood edges for staining or painting.

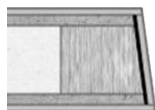

**Cutouts:** Allow 5" minimum distance from door edge and hardware cutouts.

**Standard Bevel:** 1/8"

**Clearances:** 1/8" top, 1/8" lock and hinge stiles. See NFPA-80 6.3.1.7.1, 2013 Edition. Bottom clearance 3/4" max. (bottom of the door to top finish floor) See NFPA-80 4.8.4.1, 2013 edition.

**STC Rating:** STC 33, see STC chart for requirements.

**Screw Holding and Split Resistance:**

Refer to Customer Service Update #CS119F  
(www.vtindustries.com/doors/csupdates)

**DOOR STANDARDS:**

• WDMA I.S. 1-A-2011 and AWS, Edition 2, Section 9 Quality Standards (Bonded Core).

• Top and bottom rails of door shall be factory sealed.

• Doors shall be clad in horizontal grade standard high pressure decorative laminate, meeting or exceeding NEMA Standard LD3, Type HGS, with Type 1 adhesive containing no added urea-formaldehyde. Standard colors and patterns may be selected, or custom colors, patterns, and finishes can be specified at additional cost.

\*• Positive pressure fire doors: testing, labeling and inspection by Intertek/Warnock Hersey. 45-minute available as pairs and single doors, 60-minute available as single doors. For 60-minute pairs, refer to 1P11 construction. UL 10C

• Cutouts for vision panels shall be made at the factory and shall be of sizes and locations as indicated on the drawings. Factory finished wood glazing stops or beige powder coated metal lite frames shall be furnished for lite openings unless otherwise specified.

• Cutouts for vision panels shall be made at the factory and shall be of sizes and locations as indicated on drawings. See STC chart for lite sizes and glass requirements by STC rating.

• Hardware preparation: All cutouts for mortise hardware shall be made at the factory from hardware manufacturer's templates and approved shop drawings.

• Doors shall be individually poly-bagged for protection in transit and storage periods, and shall be marked as per tag openings on shop drawings.

• Door bottoms, sweeps, thresholds, gasketing, lite kits and glass may be supplied by others or VT.