

HPDL OR PRIMED HDF

THICKNESS	1-3/4", 1-3/8", 2", or 2-1/4" (±1/16")
MAXIMUM SIZE	4'-0" x 10'-0" maximum, for oversized doors please consult VT; see fire door capability chart for rated doors
CORE	Particleboard Core (PC), ANSI A208.1, grade LD-2, 70% of door construction weight, pre-consumer recycled materials
VERTICAL EDGES (STILES)	Structural Composite Lumber (SCL) with finished mill option primed or painted
HORIZONTAL EDGES (TOP & BOTTOM RAILS)	Structural Composite Lumber (SCL) - sealed top & bottom rails
FACES	High Pressure Decorative Laminate (HPDL) Horizontal Grade Standard (HGS) meets NEMA standard LD3, or primed High Density Fiberboard (HDF)
STANDARD BEVEL	1/8" in 2" or 3°
FINISH	Primed or opaque factory paint
ADHESIVE	Type 1 adhesive
FACTORY MACHINING	Pre-drilled hinge pilot holes. All cutouts for mortise hardware should be made at the factory from hardware manufacturer's templates & approved shop drawings
QUALITY STANDARDS	WDMA I.S. 1-A & AWS, Section 9 Quality Standards (Bonded Core)
WDMA PERFORMANCE LEVEL	Heavy Duty. For extra heavy duty, blocking for hardware is required
SUSTAINABILITY	<ul style="list-style-type: none"> • CARB Phase 2 / TSCA VI Compliant • GREENGUARD GOLD or SCS Advantage Gold • FSC upon request, Consult VT for LEED documentation • Environmental Product Declaration (EPD) • Health Product Declaration (HPD)
DOOR WEIGHT	Approx. 5.5 lbs./sq. ft.
WARRANTY	Limited Lifetime, Interior use only. View warranty

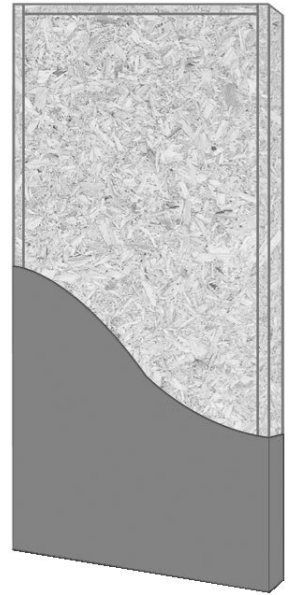

PC-3 (303H, 3P03H)

ADDITIONAL DOOR FEATURES & STANDARDS

- CUTOUTS:** 5" minimum distance from door edge & the minimum distance between lite & lock cut out is 3-5/16
- CLEARANCES:** 1/8" top, 1/8" lock & hinge stiles. See NFPA-80 6.3.1.7. Bottom clearance 3/4" max (bottom of the door to top finish floor) See NFPA-80 4.8.4.
- SECURITY RATING:** Class 40, ASTM 476 (highest rating possible)
- LABELING:** Positive pressure, Category A 20-minute Intertek/Warnock Hersey fire labels per NFPA 80 4.2. Fire-rated doors must use approved lite frames, UL 10C
- PACKAGING:** Doors shall be individually poly-bagged by request for protection & marked as per tag openings on shop drawings
- ACCESSORIES:** Door bottoms, sweeps, thresholds, gasketing, lite kits & glass may be supplied by VT or others

VT INDUSTRIES RESERVES THE RIGHT TO CHANGE DESIGN AND/OR DETAILS OF ITS PRODUCTS WITHOUT NOTICE.